

HANDWHEEL SM60/100-B05L



FEATURES:

- Ø 60 mm, height above mounting surface 25 mm only
- 100 pulses per revolution
- 2-phases-output
- TTL-compatible

GENERAL SPECIFICATION:

Elektrical Specification

Power voltage	+5 V ±5 %
Current consumption	≤ 100 mA
Allowable load	20 mA
High level signal	≥ 2.5 V
Low level signal	≤ 0.5 V
Output signals	90° displaced, TTL-comp.
Pulses per revolution	100
Response frequency	20 kHz

Environment Parameters

Concussion resistance	1000 m/s ² , 6 ms
Vibration resistance	100 m/s ² , 10 – 200 Hz
Working temperature	-10 – 50 °C
Storage temperature	-20 – 70 °C
Relative humidity	≤ 85 %
Protection level	IP 50

Additional Parameters

Normal rotate speed	≤ 200 1/min
Max. rotate speed	600 1/min
Lifetime MTBF	≥10000 hours

ELECTRICAL CONNECTION:

Terminal Assignment

Looking at the back

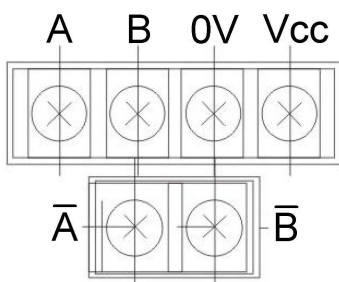

Terminal	Assignment	Terminal	Assignment
A	Signal output A	Vcc	Input voltage
B	Signal output B	A̅	Signal output A inverted
0V	Ground	B̅	Signal output B inverted

HANDWHEEL SM60/100-B05L

OUTPUT SIGNAL WAVEFORM:

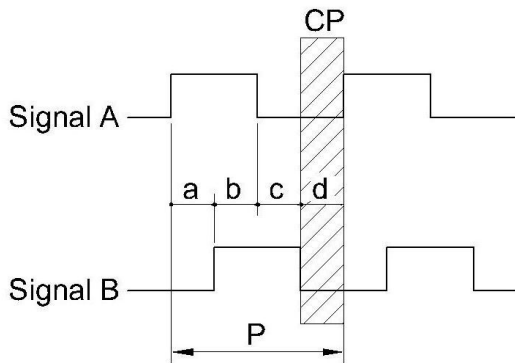

In the CP area (control point, in indexing position), both output phases have the low level status.

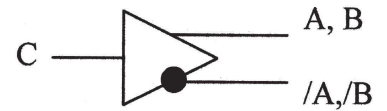

MECHANICAL DIMENSIONS:

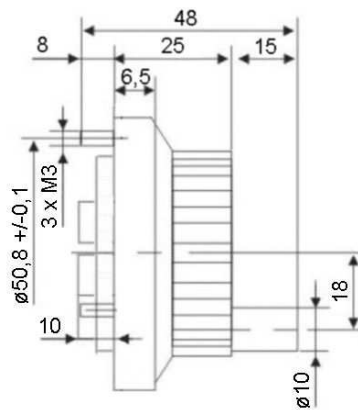
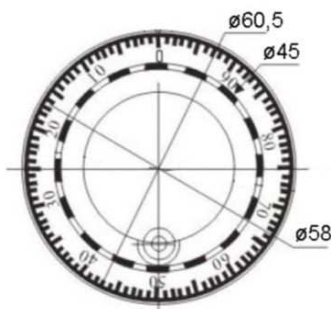

Mounting hole pattern

