

Vacuum Filter

FLS G12, G15, G20

Introduction

The filter unit consists of a housing, a removable cover, and the integrated filter element. It is designed for the filtration of the blower's intake air and prevents particles and dust from entering the blower housing. Its construction protects the internal components of the blower and contributes to long-term operational reliability. The assembly is intended exclusively for use in the blower air inlet.



Application

The filter unit is intended for use on side-channel blowers operated in dust-laden or particle-contaminated environments. It serves to filter the intake air and protect the blower from contamination, ensuring stable vacuum performance and high operational reliability.

Parameter

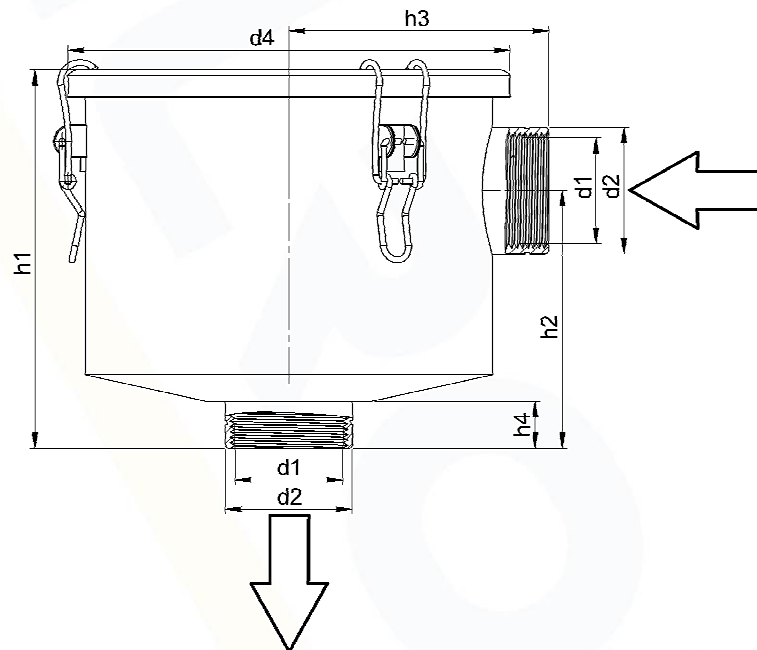

Model	d1	d2	d3	d4	h1	h2	h3	h4	Filtration	Luftdurchsatz	Gewicht
	(mm)								(Mesh)	(m³/h)	(kg)
FLS-G12	G1 1/4"	48	125	145	116	68	77	16	1000	110	1,5
FLS-G15	G1 1/2"	53	172	188	167	111	100	16	1000	210	2,3
FLS-G20	G2"	68	194	217	256	129	110	20	1000	300	4,3

Air-Filter resistance loss P= 20 mbar

Notes:

Installation: Connect the filter only to the intake port

Cleaning: Remove the filter insert for cleaning whilst the side-channel blower is shut down.

Maintenance: The filter cartridge should be checked regularly. Monthly cleaning is recommended, but may be required more frequently depending on operating conditions.

IMPORTANT: If the filter is not cleaned regularly, the service life of the side-channel blower will be reduced